



LIGHT COLUMN BOLLARD

PRODUCT DATA



PRODUCT & PRICING INFO

 **STREETSCAPES**
303.398.7040 STREET-SCAPES.COM

FORMS+SURFACES®



LIGHT COLUMN BOLLARD

PRODUCT DATA

Sleek in stainless steel, the **Light Column Bollard** integrates into a wide range of settings and offers numerous design possibilities. Bollard columns are available in 5" or 6" diameters. Illumination options include LED, RGBW LED, or linear fluorescent lamps, and multiple ways to direct light: no shield for symmetrical lighting, or 180° and 360° shields in standard or custom designs. Non-illuminated and security core variations, and matching Light Column Pathway Bollards and Light Column Pedestrian Lighting make it easy to create a cohesive look across functionalities.

MATERIAL & CONSTRUCTION DETAILS

CONFIGURATIONS	MATERIALS & FINISHES	LED LAMPS & DRIVER
<ul style="list-style-type: none"> Light Column Bollards are available in two sizes. Series 500 columns have 5" (127 mm) diameter tubular stainless steel; Series 600 columns have 6" (152 mm) diameter tubular stainless steel. To complement the illuminated bollard, a non-illuminated version is also available in both Series 500 and Series 600. Bollards can be specified with a removable base, with the exception of the RGBW LED option. Weather resistant GFCI outlet for maintenance access is available for Series 600, illuminated, non-RGBW, non-security bollards. Door for optional GFCI outlet is accessed using a flathead screwdriver. See drawings on our website for details. 	<ul style="list-style-type: none"> Illuminated bollards have a tubular stainless steel column, white-frosted acrylic lens, and a stainless steel head cap. Non-illuminated bollards are tubular stainless steel with welded stainless steel cap. Standard stainless steel finish is Satin. For optional powdercoat colors see the Forms+Surfaces Powdercoat Chart. Custom RAL colors are available for an upcharge. 	<ul style="list-style-type: none"> Custom LED light engine with Cree® LEDs. Features advanced LED technology with 17W, 3000K warm white and 4000K natural white LEDs. 17W LED driver input power is 100-277V, -30°C starting temperature. Driver has 0-10V dimming capabilities. LED driver certifications include: IP66 (waterproof) enclosure, and Class 2 rated output (UL8750)
		RGBW LED LAMPS & DRIVER
WEIGHT	SHIELD OPTIONS	FLUORESCENT LAMPS & BALLASTS
<ul style="list-style-type: none"> Series 500, illuminated: 30 lbs (14 kg); non-illuminated: 32-33 lbs (15 kg) Series 600, illuminated: 34 lbs (15 kg); non-illuminated: 34-39 lbs (15-18 kg) Series 600, security core, illuminated: 170 lbs (77 kg); non-illuminated: 177 lbs (80 kg) 	<ul style="list-style-type: none"> Four standard shield designs are available for an upcharge. Refer to page 3 for details. Custom shield designs with either 180° or 360° coverage are also available. Shields are offered for Series 500 and Series 600 illuminated and RGBW bollards. 	<ul style="list-style-type: none"> Linear fluorescent lamps are available in two options. See lamp information on page 3. Ballast is an electronic, thermally protected, 120/277V combination for two F14T5 lamps, -18°C starting temperature, <10% THD, Class A sound rating. Please call for HO ballast specifications.

INSTALLATION & MAINTENANCE

INSTALLATION	MAINTENANCE
<ul style="list-style-type: none"> Standard mounting is surface mount with 1/2"-13x18" galvanized steel J-bolt anchors. 1/2" thick stainless steel base plate is slotted for rotational capability. Security bollards have an embedded security core and are available for Series 600 bollards, except for the RGBW option, for an upcharge. All bollards, except for the RGBW option, can be specified with a removable base. RGBW bollards are connected via a daisy-chained hard-wired control signal in and out of each bollard. Installation of a surge protector as part of each units wiring is recommended. Necessary hardware is included for all mounting options. Templates are available upon request. 	<ul style="list-style-type: none"> Metal surfaces can be cleaned as needed using a soft cloth or brush with warm water and a mild detergent. Avoid abrasive cleaners.



LIGHT COLUMN BOLLARD

PRODUCT DATA

ILLUMINATED BOLLARDS

NOMINAL DIMENSIONS

SURFACE MOUNT WITH J-BOLTS

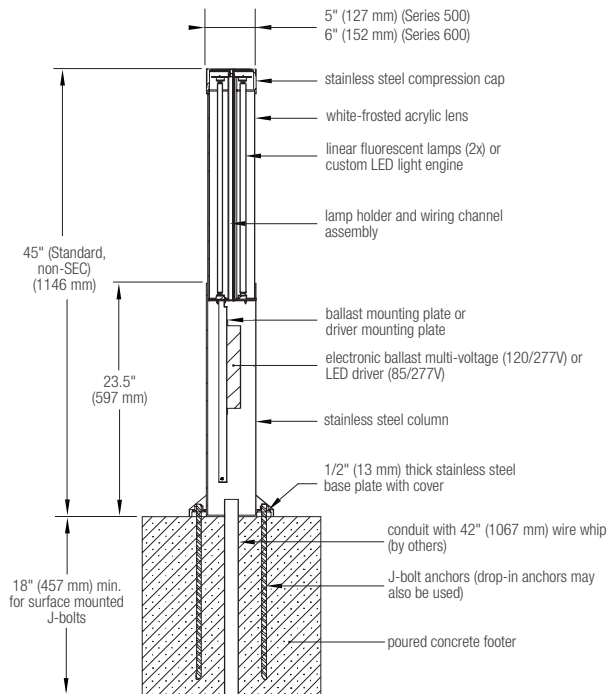

SURFACE MOUNT WITH REMOVABLE BASE*

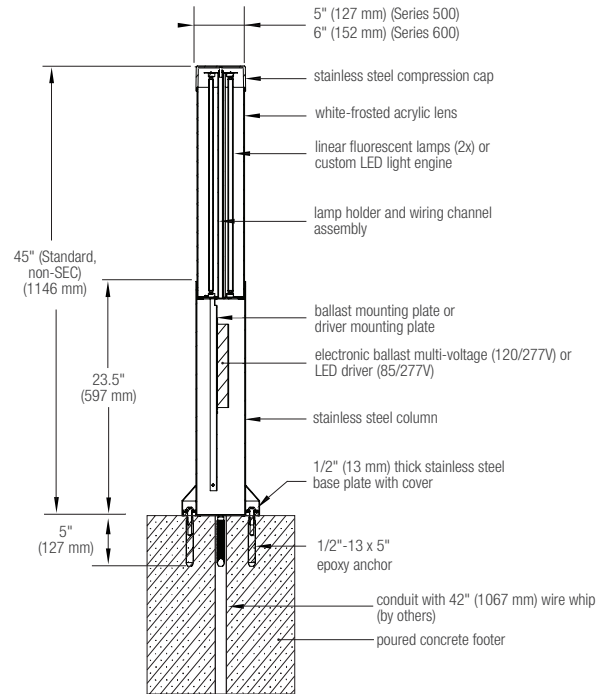

BASE PLATE MOUNTING DETAILS

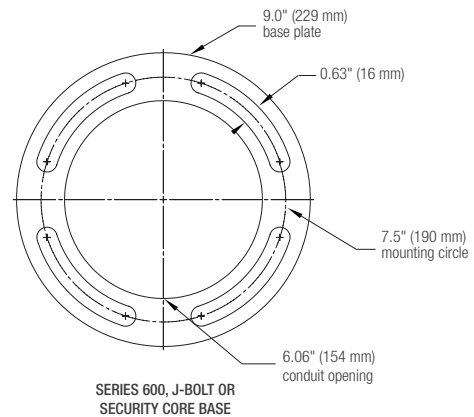
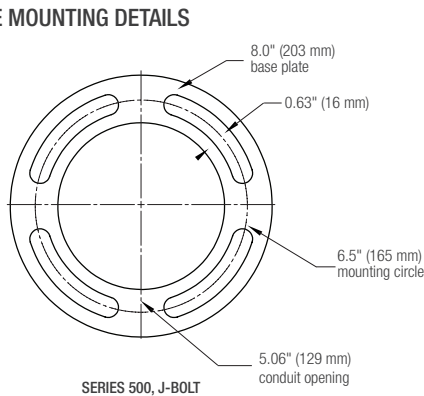

* Not Available with RGBW LED option.



LIGHT COLUMN BOLLARD

PRODUCT DATA

ILLUMINATED BOLLARDS - CONTINUED

LAMP DESCRIPTIONS

LAMP	DESCRIPTION	BASE	COLOR TEMPERATURE	LUMINAIRE LUMENS*		B.U.G. RATING	LED STARTING TEMPERATURE °C
				500	600		
3000K LED	17W custom LED light engine	N/A	3,000K	1542	1545	B1-U4-G1	-30
4000K LED	17W custom LED light engine	N/A	4,000K	1542	1545	B1-U4-G1	-30
RGBW LED	78W custom LED light engine	N/A	RGBW	varies	varies	varies	-30
(2) F14T5	14W T5 linear fluorescent	Mini bi-pin	4,100K	2220	2195	B1-U4-G2	N/A
(2) F24T5/HO	24W T5HO linear fluorescent	Mini bi-pin	4,100K	3288	3252	B1-U5-G2	N/A

*Luminaire lumens represents the absolute photometry for the luminaire, and indicates the lumens out of the entire fixture.

STANDARD SHIELD DESIGNS

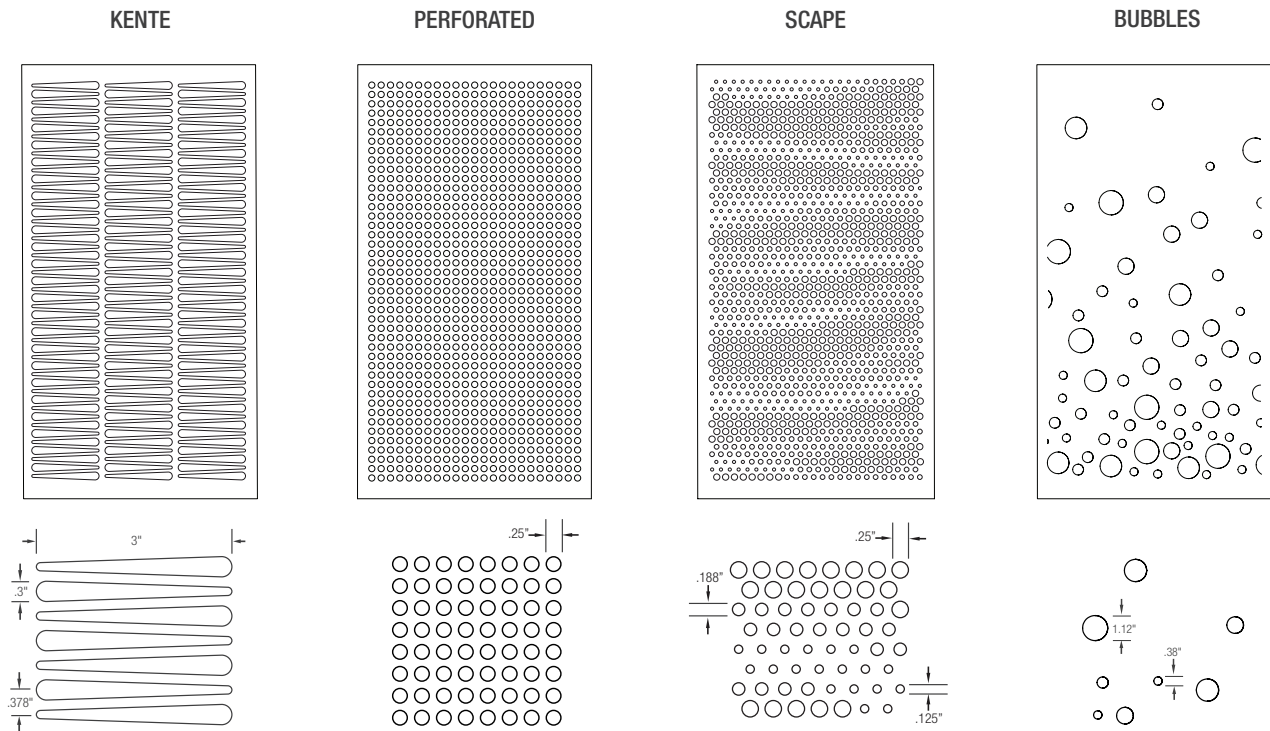

	KENTE		PERFORATED		SCAPE		BUBBLES	
	Series 500	Series 600	Series 500	Series 600	Series 500	Series 600	Series 500	Series 600
180 Bollard	N/A	•	•	•	•	•	•	•
360 Bollard	N/A	N/A	•	•	•	•	•	•

NOTE: "•" indicates that the shield design is available in the selected series and size combination.



LIGHT COLUMN BOLLARD

PRODUCT DATA

ILLUMINATED BOLLARDS - CONTINUED

NOMINAL DIMENSIONS - EMBEDDED SECURITY CORE

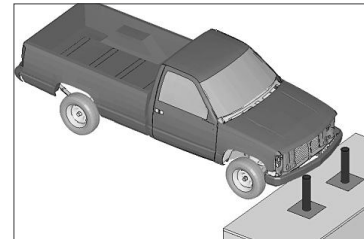
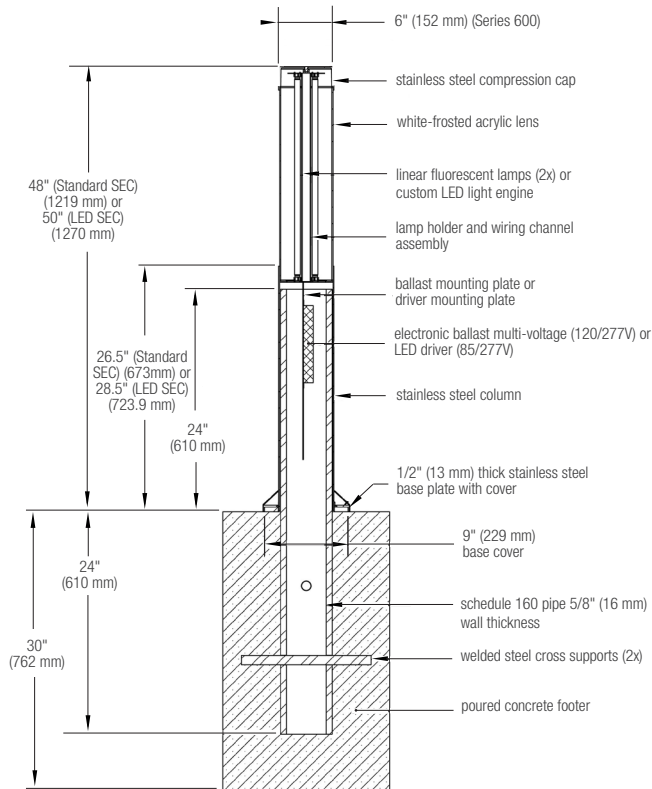

Crash scenario with 5,500 lb pickup truck approaching embedded bollard system at 40 mph

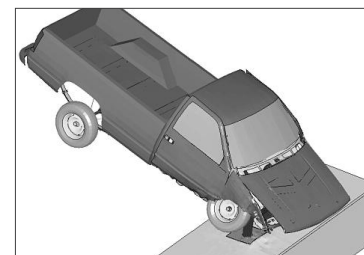

Full-scale crash 330ms after impact

OPTIONAL SECURITY CORE

Site security is a major concern in today's unpredictable world. Public and private buildings, government facilities, campuses and public parks are all susceptible to accidental, as well as deliberate vehicle infringement. Design professionals, city planners, facilities managers and engineers must now be increasingly sensitive to the safety and security requirements of public and private spaces. Security bollards placed at ingress points are an excellent way to guard against vehicle infringement while still allowing pedestrian access.

Until recently, security bollards have frequently taken the form of generic pipes or cylinders that offer little in the way of design or lighting functionality. Now, an optional enhancement to our Light Column Bollards provides a solution that blends security, performance and style. By adding a pre-engineered security core to our Series 600 design, we're able to respond to the needs of today's public spaces with a beautiful illuminated bollard that meets stringent high-impact crash requirements.

Forms+Surfaces' security bollards have been tested using a Finite Element Analysis (FEA) by a professional engineering consultant. FEA is a software-based tool commonly used in the automotive industry and used extensively for crash test simulations. Tests were performed using our bollards set in permanent concrete footings spaced 42" center-to-center apart (to assure a minimum of two bollards being hit) and struck by a vehicle at a 90 degree impact. The impact simulation found the bollards to be successful in stopping a 5,500 lb. vehicle traveling at a minimum test velocity of 40 mph.

In addition to our illuminated security bollards, we can also provide non-illuminated options. Refer to page 5 for details. Note that security cores are not available with the RGBW LED option. Please contact Streetscapes to discuss design and installation considerations for Light Column Bollards with security cores.



LIGHT COLUMN BOLLARD

PRODUCT DATA

NON-ILLUMINATED BOLLARDS

NOMINAL DIMENSIONS

SURFACE MOUNT WITH REMOVABLE BASE

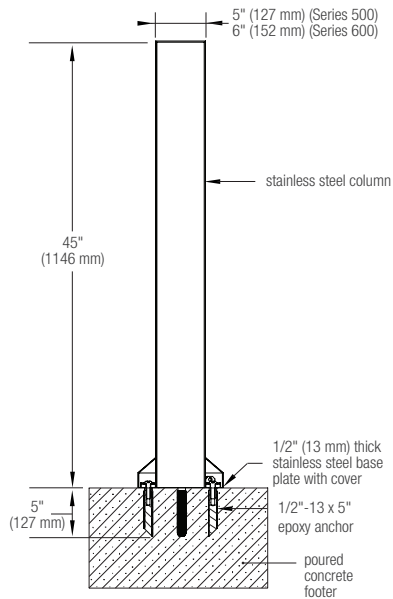

SURFACE MOUNT WITH J-BOLTS

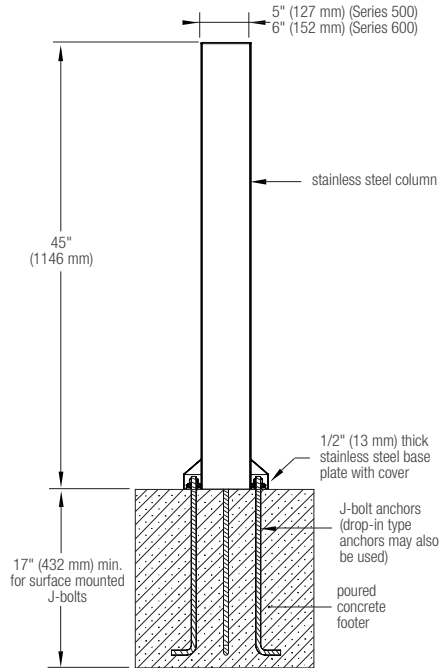

EMBEDDED SECURITY CORE

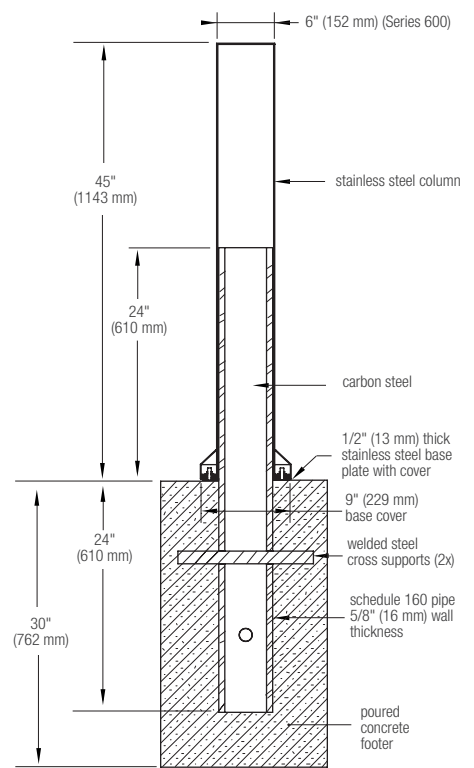

BASE PLATE MOUNTING DETAILS

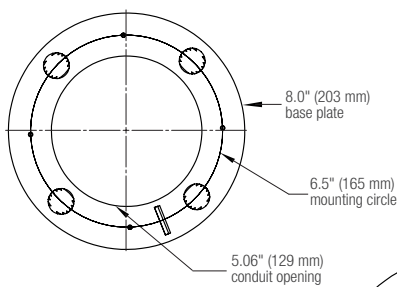

SERIES 500, REMOVABLE BASE

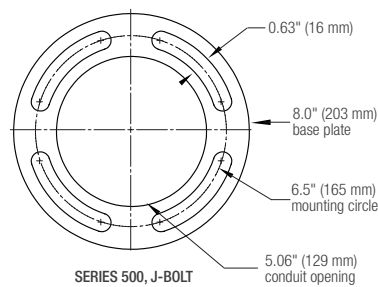

SERIES 500, J-BOLT

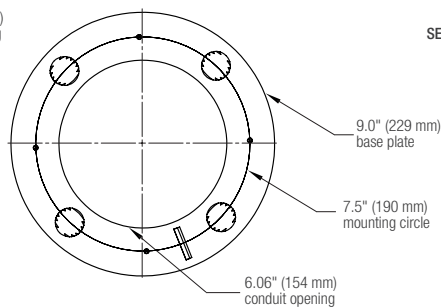

SERIES 600, REMOVABLE BASE

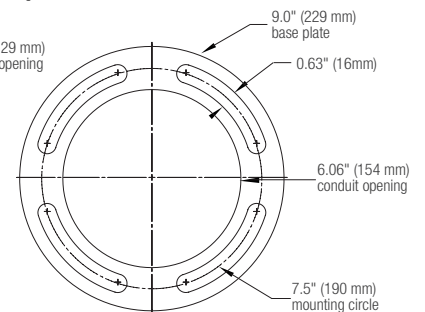

SERIES 600, J-BOLT OR SECURITY CORE BASE



LIGHT COLUMN BOLLARD

PRODUCT DATA

CERTIFICATIONS

- UL and C-UL listed for wet locations (linear fluorescent).
- ETL and C-ETL listed for wet locations (LED).

ENVIRONMENTAL CONSIDERATIONS

- Please refer to the Light Column Bollard Environmental Data Sheets for detailed environmental impact information.
- Light Column Bollard has high recycled content and is highly recyclable.
- Powdercoat finishes are no- or low-VOC, depending on color.
- Low maintenance.

MODEL NUMBERS AND DESCRIPTIONS

MODEL	DESCRIPTION
LBLCO-504	Light Column Bollard, Series 500, illuminated
LBLCO-604	Light Column Bollard, Series 600, illuminated
LBLCO-504-RGBW	Light Column Bollard, Series 500, illuminated, RGBW
LBLCO-604-RGBW	Light Column Bollard, Series 600, illuminated, RGBW
LBLCO-504-N	Light Column Bollard, Series 500, non-illuminated
LBLCO-604-N	Light Column Bollard, Series 600, non-illuminated

PRODUCT OPTIONS

The following options are available for an upcharge

Upgrade to embedded security core (available for Series 600)*	Add 360° custom shield (customer-supplied artwork)
Upgrade to removable base*	GFCI outlet (available for Series 600, illuminated, non-security bollards)*
Add 180° perforated shield in standard designs	Add powdercoat color from Forms+Surfaces Powdercoat Chart
Add 360° perforated shield in standard designs	Custom RAL powdercoat color
Add 180° custom shield (customer-supplied artwork)	Custom fixture height

*Not available with RGBW LED option.

TO ORDER SPECIFY: Quantity, model, finish, lamp, shield (if applicable), and mounting.

NOTE: Because different computers will render colors and textures differently, actual colors and finishes may vary slightly from those shown here.